

AN EXPERIENCE IN THE CENTRE OF LISBON

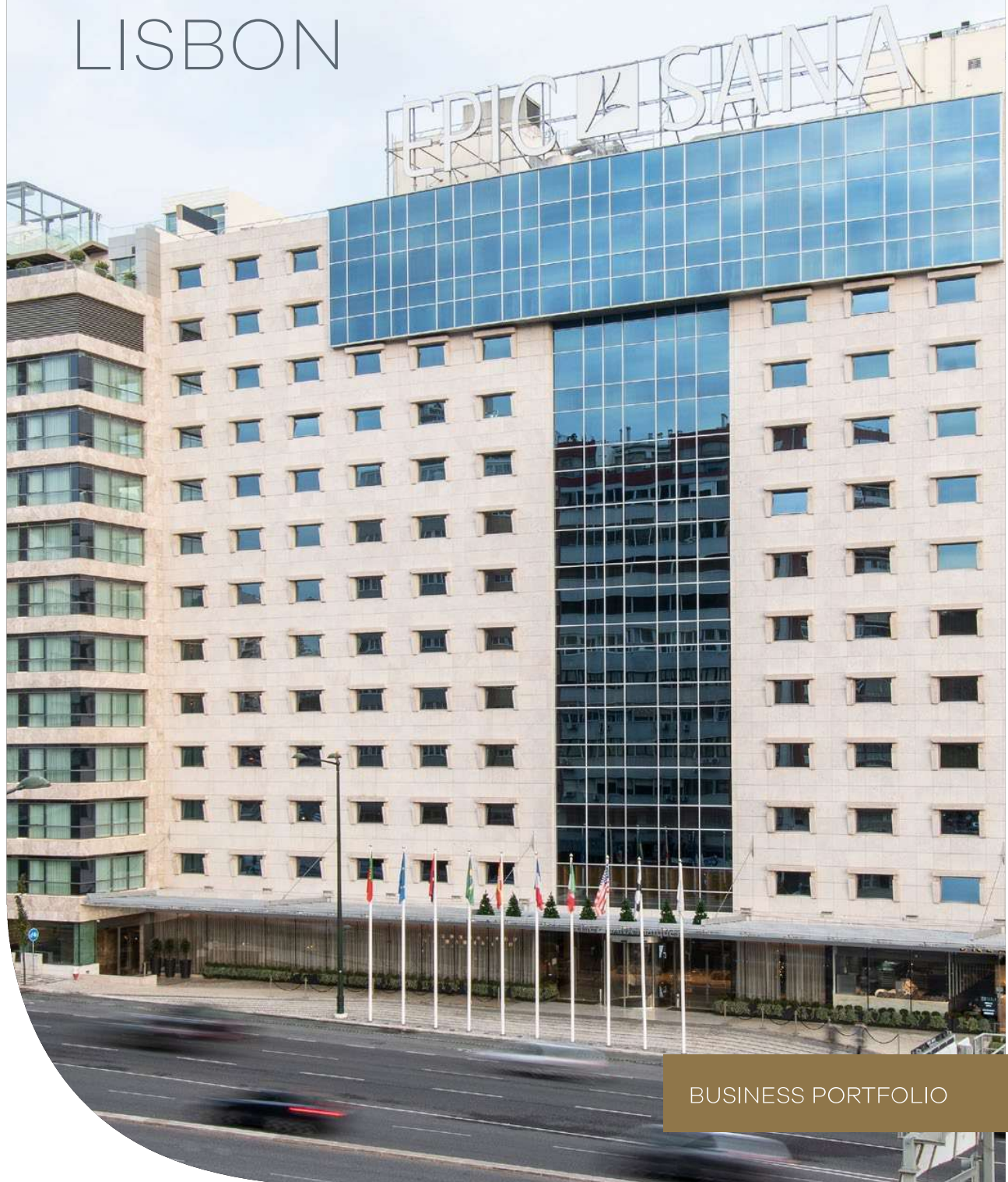

BUSINESS PORTFOLIO



CONTENTS

- EPIC SANA Marquês
- MICE
- Corporate
- Social Events and Weddings
- Food and Beverage
- SAYANNA Wellness & SPA
- SAN.IA
- SANA Group
- Contacts



WELCOME TO EPIC SANA MARQUÊS

Expect nothing less
than memorable experiences!

LUXURY AND EXCLUSIVITY

*EVERYTHING TO PROVIDE
YOU AN EPIC STAY*

After or before a long day of business or sightseeing in Lisbon, experience our impressive cosmopolitan Hotel that proposes vibrant and versatile facilities in the heart of a dynamic urban capital, being the trendy place to meet, work, enjoy, relax and stay.

The hotel's excellent location, on Avenida Fontes Pereira de Melo in the city center, makes EPIC SANA Marquês the best choice for those who visit Lisbon.

_ HOTEL FACADE



Reception/Concierge and Room Service
 24h Staff Multilingual
 3 Restaurants, 3 Bars, and Roof Top
 Conference Centre and Events
 SAYANNA Wellness & SPA
 Laundry Service
 Valet Parking / Indoor Parking (204 parking spaces)
 Drop-on and drop-off at the main entrance for 2 buses
 Air conditioning
 Wi-Fi
 Fire detection and fire fighting system
 CCTV system
 DAE system
 Business center
 Press Reader
 Outdoor Swimming Pool

Services
 Hotel Facilities_



_ LOBBY



_ FRONT DESK



_ PROMOTIONAL VIDEO

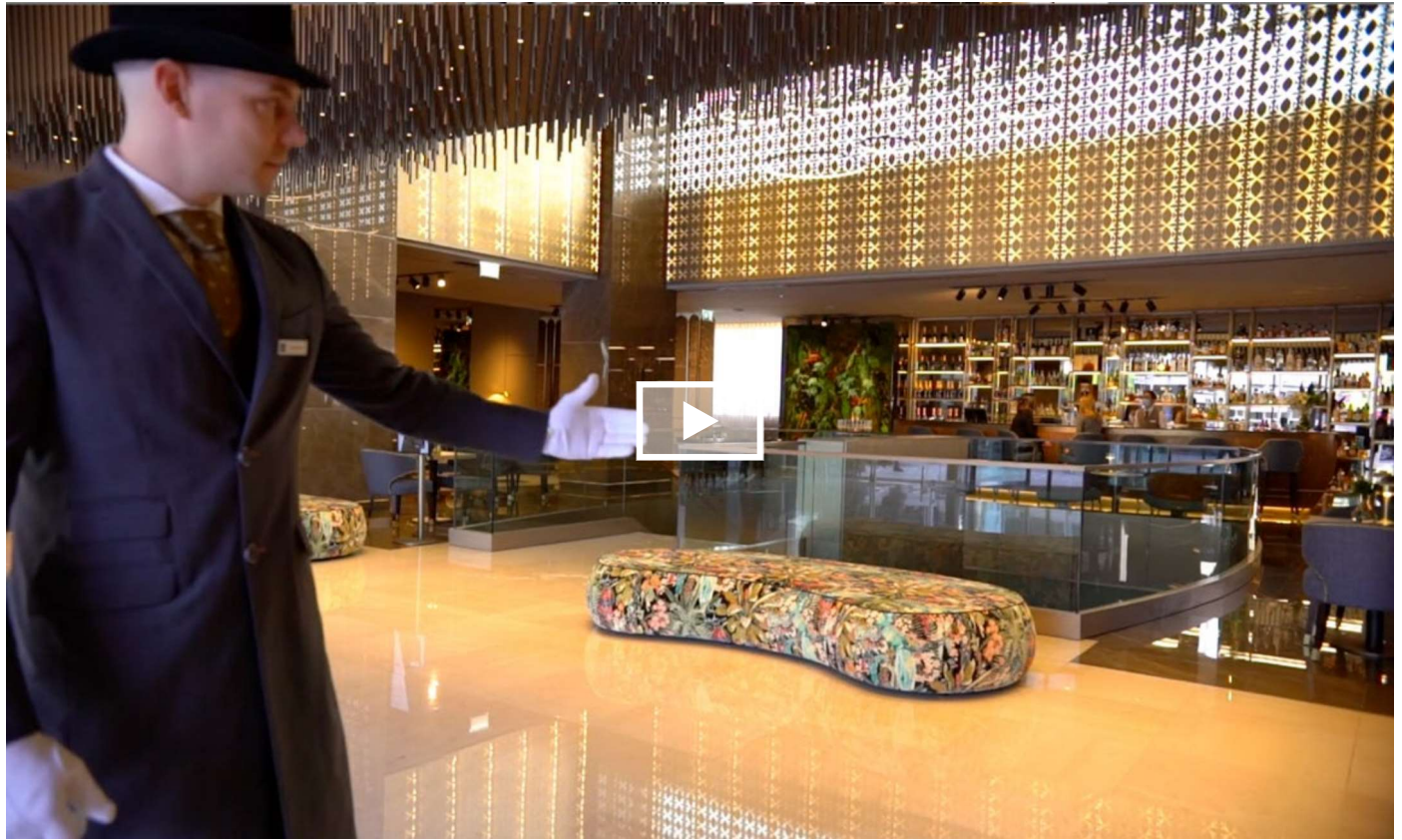

PRIVILEGED LOCATION

IN LISBON'S CITY CENTER, ONE OF EUROPE'S MOST DAZZLING CAPITALS

In the heart of the city, next to Marquês de Pombal Square.

EPIC SANA Marquês has a privileged location by being in the middle of the city and offering access to all possible activities and the most emblematic monuments with excellent access points and easy transport facilities. Only 15 minutes from the airport.

_TEMPERATURE



SPRING

20°C ▲▼ 15°C



SUMMER

32°C ▲▼ 18°C



AUTUMN

17°C ▲▼ 12°C



WINTER

15°C ▲▼ 9°C

_ MARQUÊS DE POMBAL SQUARE



Marquês de Pombal Square

Parque Eduardo VII

Estufa Fria

Avenida da Liberdade

Rossio

Baixa de Lisboa

Praça do Comércio

Cinamateca

Theaters: Teatro Tivoli BBVA, Politeama, Teatro Nacional D. Maria II

Cultural places: Coliseu dos Recreios, Museu e Jardins Calouste

Gulbenkian

Shopping centre: El Corte Inglés, Amoreiras Shopping Center,

Atrium Saldanha

ACCESSES

Metro: Marquês de Pombal e Picoas – yellow and blue lines

Airport

Surrounding Area_

EPIC SANA MARQUÊS LOCATION

QUICK ACCESS TO THE MOST IMPORTANT PLACES

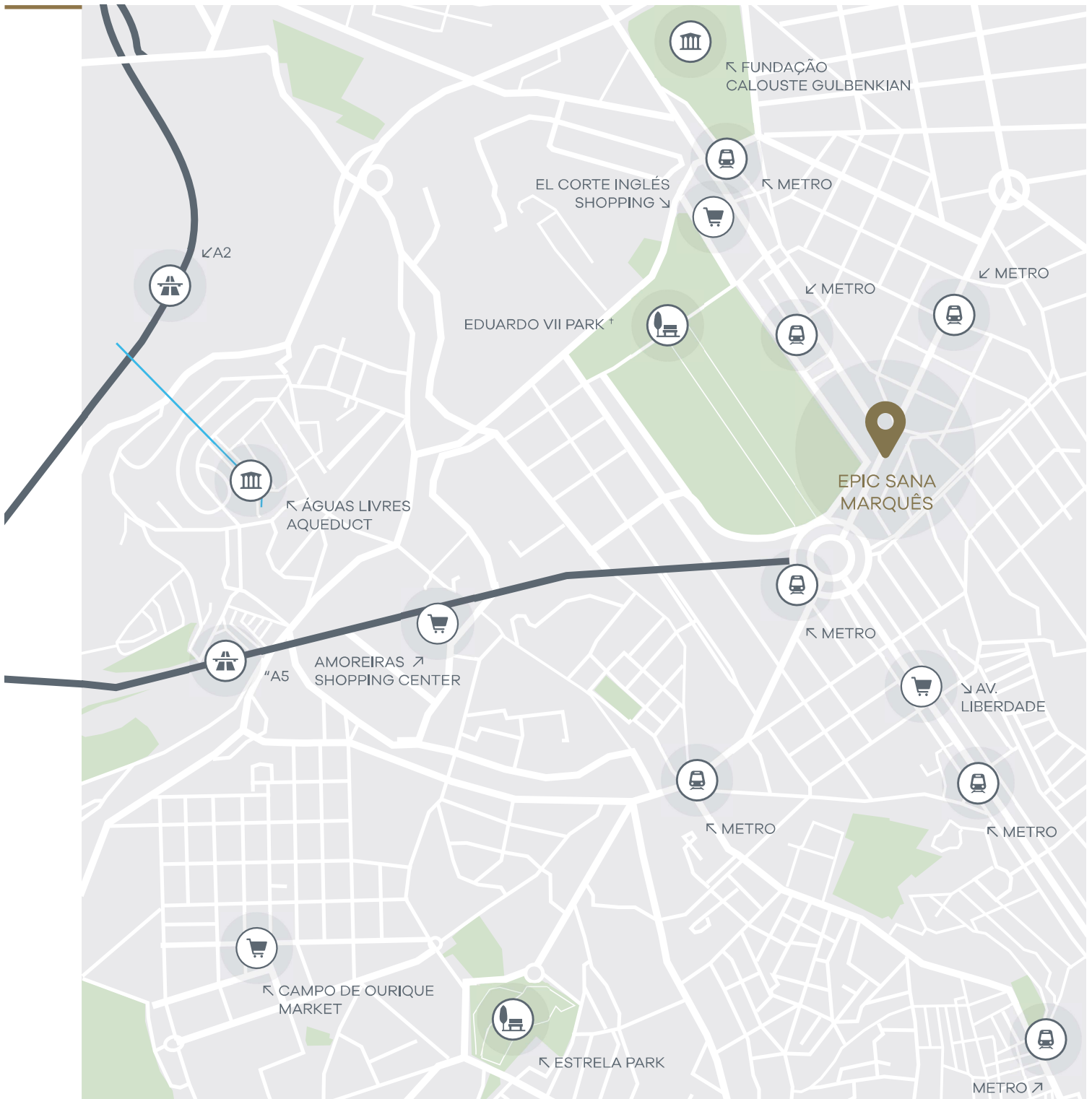

ACCOMMODATION

MODERN LUXURY EXPERIENCE

The EPIC SANA Marquês offers the elegance of comfort in a contemporary stay. With 341 rooms and 38 suites, many with stunning views over Lisbon's most emblematic sights.

257 / DELUXE (25 - 27 sqm)

84 / PREMIUM (31 sqm)

37 / SUITES (47 - 56 sqm)

1 / SUITE PRESIDENCIAL (70 sqm)



_ PREMIUM DOUBLE ROOM



- Wi-Fi
- Telephone
- Smart TV (Cable and Netflix)
- Air conditioning
- Double Glazing
- Mini-Bar
- Digital Safe
- Iron and Ironing Board
- Walk-in Shower (Premium) | Bathtub (Deluxe)
- Hair dryer
- 2 rooms for guests with reduced mobility

Services & Facilities_

_ DOUBLE DELUXE ROOM



_ PRESIDENTIAL SUITE



_ PREMIUM SUITE VIEW



ALLORA RESTAURANT

*A JOURNEY TO THE ESSENCE
OF ITALIAN GASTRONOMY*

With independent access from the EPIC SANA Marquês, ALLORA is an Italian cuisine restaurant full of elegance.

Inspired by the famous Italian Trattorias, Allora has an open kitchen, an antipasti bar, a cocktail bar, an ice cream and dessert area, and a covered terrace with an incredible view over the city, reminiscent of a real "Giardino All'Italiana".

_ ALLORA RESTAURANT



_ ALLORA RESTAURANT



KOJI RESTAURANT

*JAPANESE CULINARY HERITAGE IN AN
ATMOSPHERE OF ELEGANCE AND SOPHISTICATION*

Indulge yourself with the exotic flavors of our soft authentic Japanese cuisine.

You will not be indifferent to the Zen-inspired ambience or the elegant lounge and terrace with a breathtaking view over the city of Lisbon.

Enjoy an immersive gastronomic experience at KOJI Bar and Restaurant, on the 12th floor of the EPIC SANA Marquês and accompany your meal with one of the Japanese whiskies or sakes from our refined collection, or a wine selection from our wine cellar.

_ KOJI RESTAURANT



_ KOJI RESTAURANT



THE GARDEN RESTAURANT

*A DELICIOUS BREAKFAST IN
A TROPICAL SETTING*

THE GARDEN'S magnificent and sophisticated breakfast buffet is the ideal way to start the day.

The variety of carefully selected products makes the first meal of the day an invigorating moment.



_ BREAKFAST



_ THE GARDEN



SKY POOL LOUNGE

AN EXCLUSIVE EXPERIENCE ON THE TOP OF THE CHARMING LISBON CITY

The pool bar offers trendy service and a close-up bar concept, enhancing the experience of our guests with signature cocktails, special or classic, always accompanied with a menu of delicious and elegant snacks.

Sit back, sip your champagne, and be mesmerized by the view!



_ CITY VIEW



_ SKY POOL LOUNGE



BE EPIC BAR

*EXPLORE THE BAR LIST
AND CHOOSE YOUR FAVORITE DRINK*

With natural green vertical walls and intimate seating areas with a piano alongside, the BE EPIC Bar is designed both to work as well as to relax. On the extension of the bar, you can also find an urban garden.

You can sit in, enjoy the view, and read a newspaper with your preferred drink and company.



_ BE EPIC BAR - INDOOR



_ BE EPIC BAR – WINTER GARDEN



SAYANNA WELLNESS & SPA

*THE ULTIMATE JOURNEY TO
INDULGE YOUR BODY, MIND & SOUL*

With 700sqm SAYANNA Wellness & SPA at EPIC SANA Marquês is one of the most fantastic SPA's in central Lisbon.

With a soulful asian-urban concept this urban oasis of serenity has a vitality pool with a stunning and unique decoration, combining the elements of water and fire to warm the ambiance. It also has a gym with the most advanced Technogym equipment.

_ SAYANNA ENTRANCE



3 Private treatment rooms

1 Double SPA suite

Sensorial showers

Sauna and Steam Room

Vitality Pool

Beauty Treatments:

Facial cleansing, Manicure, Pedicure

SPA Daily 9 am – 10 pm

GYM 24/7

Services_

MEETING ROOMS

*AN INSPIRING CONFERENCE CENTER
FOR SUCCESSFUL MEETINGS AND EVENTS*

The Conference and Events Centre of the EPIC SANA Marquês includes a total of 2142 sqm, distributed over 2 floors with 18 extraordinarily versatile rooms with a capacity of up to 1500 participants.

The perfect place for all events including conferences, AGMs and exhibitions, launch events, fashion shows, gala dinners, wedding receptions, and other social and corporate events. There are also discreet spaces, perfect for smaller events and break-out rooms.

_ BUSINESS CENTER_FOYER



_ ESTRELA ROOM IN CLASSROOM



Features_

- Integrated AV Equipment
- Sound Control and Light System
- Access for people with reduced mobility
- Natural light
- Air conditioning
- Coffee Station and Coffee Break, Cocktail, Menus, and Buffets
- Wi-Fi
- Electronic Blackouts



MICE

2142 sqm fully flexible and well-equipped and dedicated teams, for the most varied events, with solutions that suit your requirements.

BUSINESS CENTER

SOLUTIONS FOR ANY NEED

With a team dedicated to your event, the EPIC SANA Marquês promises to transform your event into an unforgettable moment.

The EPIC SANA Marquês has various spaces for events and meetings, with a total area of 2142sqm.

The rooms are distinguished by their flexibility and quality of equipment, allowing to host various types of events such as congresses, cocktails, exhibitions... your imagination is the limit.

_ FOYER

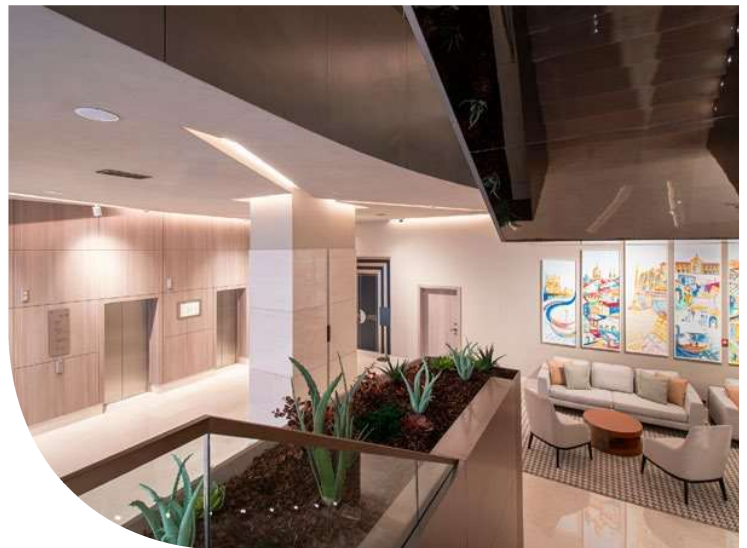

Features and Services_

-  **Audiovisual material**
 (Projection with LEDWall, HD LCD or Projector, and screen. Sound System with central remote control, advanced lighting control system. Sockets protected by UPS and single and three-phase connections)
-  Access for people with reduced mobility
-  Natural light
-  Air conditioning
-  Coffee Station, Coffee Break, Cocktail, Menus and Buffets
-  Free Wi-Fi
-  Electronic Blackouts
-  Light and Sound Control System

FLOOR -1

GENERAL FEATURES

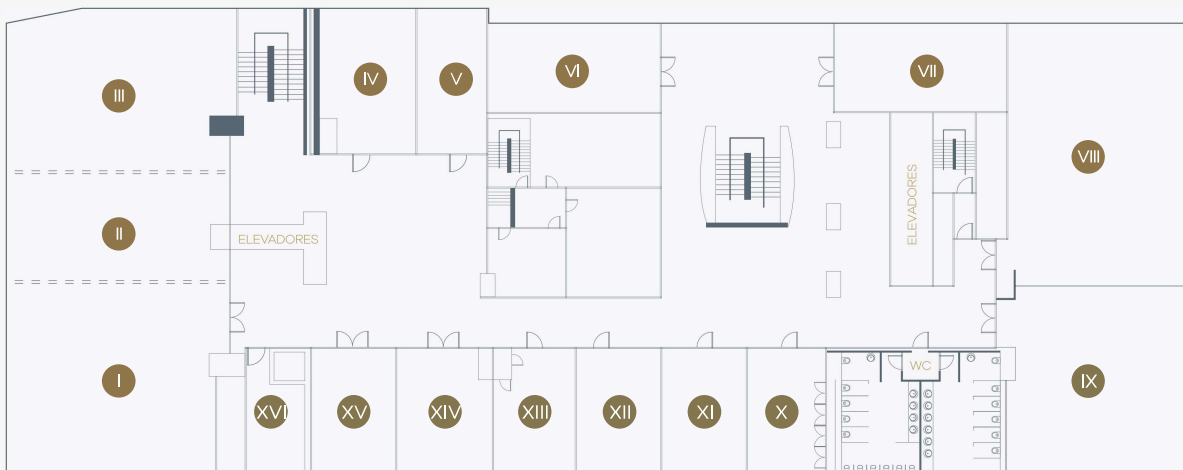



Areas
1256 sqm

- | | | | |
|------|--------------------|------|--------------------|
| I | Chiado I 158 sqm | IX | Alfama II 132 sqm |
| II | Chiado II 99 sqm | X | Castelo I 48 sqm |
| III | Chiado III 148 sqm | XI | Castelo II 48 sqm |
| IV | Lapa I 56 sqm | XII | Castelo III 48 sqm |
| V | Lapa II 40 sqm | XIII | Castelo IV 48 sqm |
| VI | Estrela I 72 sqm | XIV | Carmo I 42 sqm |
| VII | Estrela II 72 sqm | XV | Carmo II 38 sqm |
| VIII | Alfama I 187 sqm | XVI | Graça I 20 sqm |

FLOOR -1







MEETING ROOMS CAPACITIES AND SPECIFICATIONS

	Area	Dimensions*	 Theatre	 Classroom	 U shape	 O shape	 Banquet	 Cabaret	 Cocktail
I Chiado I	158 sqm	12.7 x 11.5 m	153	2-3 pax 56 - 84	2-3 pax 26 - 39	2-3 pax 36 - 54	set menu buffet 110 - 70	6 - 5 pax 42 - 90	w/ bistros 190
II Chiado II	99 sqm	12.7 x 7 m	110	42 - 63	24 - 36	28 - 42	60 - 50	30 - 45	120
III Chiado III	148 sqm	12.7 x 10 m	154	56 - 84	28 - 42	36 - 54	100 - 70	42 - 75	180
IV Lapa I	56 sqm	6.2 x 9 m	70	18 - 27	14 - 21	20 - 30	30 - 30	18 - 25	-
V Lapa II	40 sqm	4.4 x 9 m	30	14 - 21	10 - 15	12 - 18	30 - 30	-	-
VI Estrela I	72 sqm	6 x 12 m	56	20 - 30	16 - 24	20 - 30	30 -	18 - 30	85
VII Estrela II	72 sqm	6 x 12 m	56	20 - 30	16 - 24	20 - 30	30 -	18 - 30	85
VIII Alfama I	187 sqm	11 x 17 m	200	60 - 90	32 - 48	40 - 60	140 - 120	72 - 100	225
IX Alfama II	132 sqm	11 x 12 m	100	40 - 60	24 - 36	32 - 48	80 - 60	36 - 65	160
X Castelo I	48 sqm	6 x 8 m	30	14 - 21	10 - 15	12 - 18	-	-	-
XI Castelo II	48 sqm	6 x 8 m	30	14 - 21	10 - 15	12 - 18	-	-	-
XII Castelo III	48 sqm	6 x 8 m	30	14 - 21	10 - 15	12 - 18	-	-	-
XIII Castelo IV	48 sqm	6 x 8 m	30	14 - 21	10 - 15	12 - 18	-	-	-
XIV Carmo I	42 sqm	5.2 x 8 m	30	14 - 21	10 - 15	12 - 18	-	-	-
XV Carmo II	38 sqm	4.7 x 8 m	30	14 - 21	10 - 15	12 - 18	-	-	-
XVI Graça	20 sqm	3.6 x 4.7 m	-	-	6 - 9	8 - 12	-	-	-

* Height 3.5 m

FLOOR -1

MEETING ROOMS CAPACITIES AND SPECIFICATIONS

	Area	Dimensions*	 Theatre	 Classroom	 U shape	 O shape	 Banquet	 Cabaret	 Cocktail	
				2 - 3 pax	2 - 3 pax	2 - 3 pax	set menu buffet	6 - 5 pax	w/ bistros	
Hall -1	2142 sqm			COCKTAIL 1800 PAX						
Chiado I + II	257 sqm	12.7 x 18.5 m	297	106 - 159	38 - 57	48 - 72	210 - 180	108 - 160	305	
Chiado II + III	247 sqm	12.7 x 17.3 m	286	98 - 147	32 - 48	48 - 72	200 - 140	84 - 115	295	
Chiado I + II + III	405 sqm	12.7 x 28.7 m	477	186 - 279	60 - 93	72 - 108	320 - 280	168 - 265	500	
Lapa I + II	96 sqm	10.6 x 9 m	112	36 - 54	22 - 33	28 - 42	50 - 40	24 - 40	115	
Alfama I + II	319 sqm	11 x 29 m	340	114 - 171	56 - 84	64 - 96	220 - 180	108 - 190	380	
Castelo I + II / III + IV	96 sqm	12 x 8 m	64	36 - 54	20 - 30	22 - 32	-	30 - 45	-	
Castelo I + II + III / II + III + IV	144 sqm	18 x 8 m	110	56 - 84	32 - 48	34 - 50	-	48 - 70	130	
Castelo I + II + III + IV	192 sqm	24 x 8 m	150	76 - 114	40 - 60	42 - 62	-	66 - 90	180	

* Height 3.5 m

FLOOR -1

GENERAL TECHNICAL FEATURES



AIR CONDITIONING AND LIGHTING

Climate Control: Automatic
 Natural Light: Yes
 Blackout: Yes
 Lighting Control: Yes

ACCESS

1 Central Stair
 7 Elevators

DOORS

Width: 90cm

DATA AND VOICE

Wi-Fi – 1Gbps bidireccional

OTHER INFORMATION

All rooms have an info board screen
 outside - 22" FHD portrait format

SCREENS

PACKED SCREENS: Inceiling – 6 Chiado II and Chiado III, Estrela I and II, Lapa I (3,5 X 2m), Alfama II (4,5m X 2,5m) PORTABLE SCREENS: Lapa II (75")
 FIXED DISPLAYS: 6 - Carmo I and II; Castelo I to IV (75")

LEDWALL

2 – Chiado I and Alfama I (4,5 m X 2,5 m FHD)

PROJECTION

Built-in Projectors: 6
 Chiado II and Chiado III, Estrela I and II,
 Alfama II, Lapa I (full HD, LCD laser 5000 lumens)

SOUND EQUIPMENT

Integrated sound system for
 broadcasting audio content and voice: Yes
 Chiado I+II+III - 12 Speakers
 Passive 200W + 6 320W Subwoofers
 Alfama I+II - 10 Passive 200W Speakers
 + 5 x 320W Subwoofers Remaining Rooms (in each room)
 - 2 x 75W Speakers + 1 x 160W Subwoofer

OTHER INFORMATION

Three-phase 63rd power socket
 Chiado I, II, III + Alfama I, II

FLOOR -2

GENERAL FEATURES

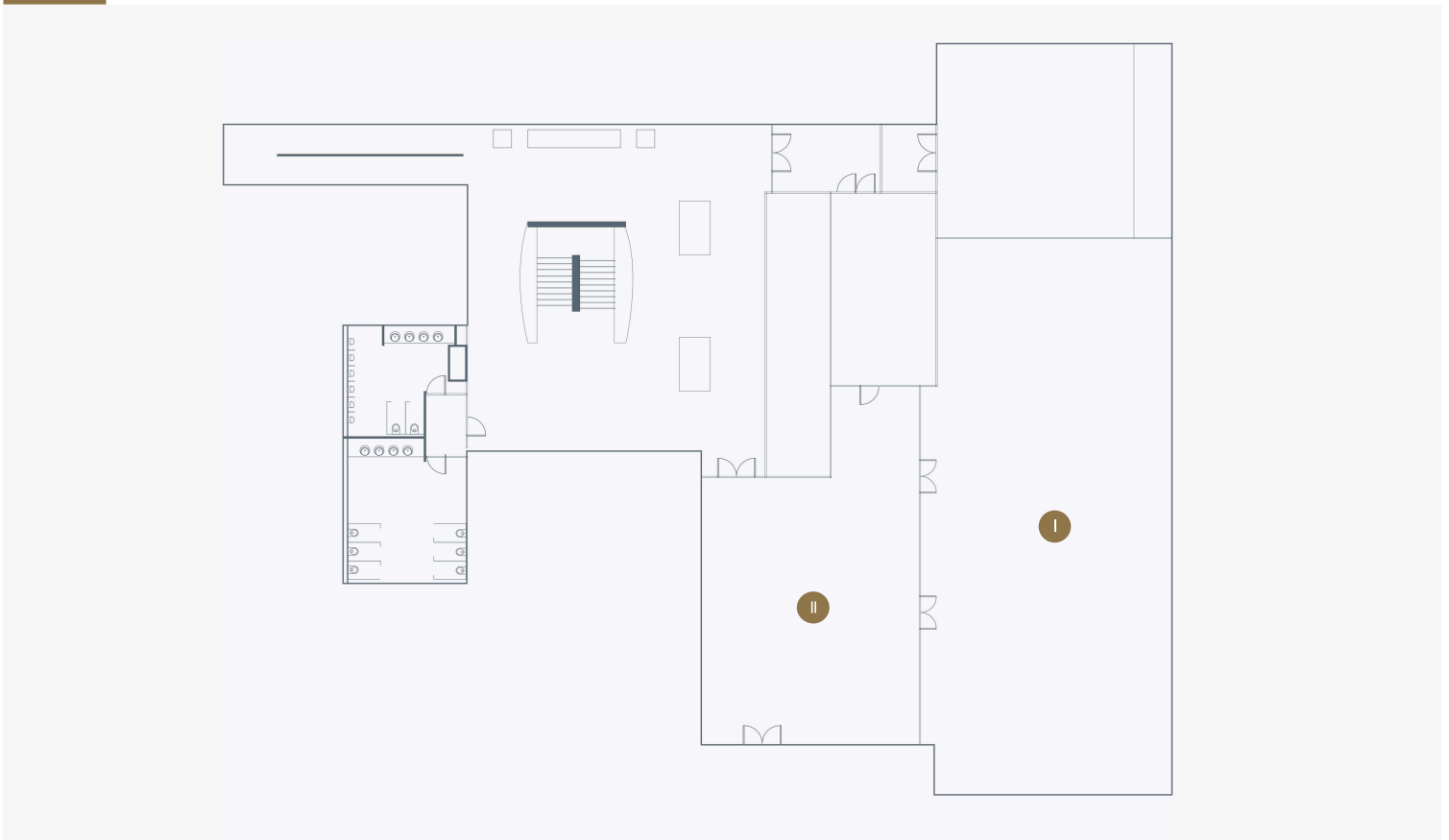







Total Area
425 sqm

- I Gala Ballroom I 305 sqm
- II Gala Ballroom II 120 sqm

FLOOR -2

MEETING ROOMS CAPACITIES AND SPECIFICATIONS

	Area	Dimensions*	 Theatre	 Classroom	 U shape	 O shape	 Banquet	 Cabaret	 Cocktail
I Gala Ballroom I	305 sqm	11.5 x 28.5 m	340	2 - 3 pax 114 - 171	2 - 3 pax 56 - 84	2 - 3 pax 68 - 102	set menu buffet 220 - 180	6 - 5 pax 108 - 160	w/ bistros 350
II Gala Ballroom II	120 sqm	10.2 x 10.3 m	100	40 - 60	22 - 33	36 - 54	70 - 50	30 - 45	140
Gala Ballroom I + II	425 sqm	12.7 x 11.5 m	-	-	-	-	300 - 230	-	510

* Height 3.2 m

FLOOR -2

GENERAL TECHNICAL FEATURES



AIR CONDITIONING AND LIGHTING

Climate Control: Automatic
Natural Light: Yes
Blackout: Yes
Lighting Control: Yes

ACCESS

1 Central Stair
1 Side Stair
7 Elevators
2 Exterior doors

DOORS

Width: 90cm

DATA AND VOICE

Wi-Fi – 1Gbps bidireccional

OTHER INFORMATION

All rooms have an info board screen outside
- 22" FHD portrait format

LEDWALL

2 - Gala Ballroom I (4,5 MX 2,5 m FHD)
+ Gala Ballroom II (3 MX 1,75 m FHD)

SOUND EQUIPMENT

Integrated Sound System for
broadcasting audio content and voice: Yes
Gala Ballroom I+II - 16 passive 200W
speakers + 8 320W subwoofers de 200W
+ 8 Subwoofers de 320W

_ CHIADO ROOM IN THE THEATER



_ COFFEE STATION



_ ALFAMA ROOM IN CABARET



_ ESTRELA ROOM IN BOARDROOM



_ COFFEE BREAK





CORPORATE

Welcome to EPIC SANA Marquês and to this exclusive group of top corporate Clients.

EPIC SANA MARQUÊS CORPORATE

*WHERE THE SURROUNDING SPACE
INSPIRES TO WORK*

Every day we strive to evolve our product so that we can better assist you.

We know that time is important to you, but we also know that a corporate stay does not have to be disassociated from a multisensory experience. We want you to enjoy your stay with us to the maximum, and meet your needs and expectations.

Here you will find dedicated customer service, with a team of excellent professionals always available to assist you.

Challenge us with your wishes, we are here to turn your dreams into reality.

_ GALA BALLROOM



Services_

- Valet Parking
- Guest Relations
- Digital Butler Service - 24h
- Room Service - 24h
- Business Center
- Fitness Center
- Indoor Swimming Pool
- SAYANNA Wellness & SPA
- Laundry / Dry Cleaning
- Meeting Rooms
- Free Wi-Fi

SANA CARD

COLLECT EXCLUSIVE BENEFITS
AS A PREFERRED CUSTOMER

With SANA Card, benefit from a world of exclusive advantages designed to ensure your well-being.

Targeted to Corporate clients, SANA Card can be used at all SANA Group Hotels and grants you a 15% discount on the best available rate for bookings made at sanahotels.com or directly with the hotel.

To turn your stay into a memorable experience, benefit from the offer of Wi-Fi, early check-in and late check-out.



Advantages and Benefits

10% discount in the Hotels restaurants and bars (up to 9 people)

10% discount on Laundry Service

VIP treatment upon arrival

Parking (exclusive for accommodated guests and subject to availability)

Dedicated Corporate Promoter
Personalized solutions
24h / 365 Reservation Center
Flexibility in your reservations

Personalized offers

LAPA ROOM – U SHAPE



MEETING ROOMS

A selection of versatile meeting rooms that can be adapted to suit your projects and an events team totally dedicated to you.

Total Area
2142 sqm

8 rooms + 2 Foyer / capacity until 1.500 participants



GALA BALLROOM

*PERFECT COMBINATION OF ELEGANCE
WITH MODERN TECHNOLOGY*

A magnificent gala ball room located in of vibrant capital with excellent access points, offering amazing flexibility to host cocktail receptions, dinner and dance shows, award ceremonies, fashion shows, corporate and social events and all large life events to celebrate.

Our ballroom with its imponent entrance, high ceilings and natural light, outstanding and sophisticated decoration and state-of-the-art audio visual and smart lighting system, creates the perfect combination of elegance with modern technology, never failing to impress guests

_ GALA BALLROOM



CAPACITY & RESOURCES

- Standing / Cocktail 500 | Dinner 200
- 425 sqm
- Natural Light
- With LED wall
- Three-phase 63amp
- Kitchens
- Wedding License
- Access for people with reduced mobility
- Unloading dock
- Parking

_ KOJI



_ ALLORA



_ THE GARDEN



_ SKY POOL LOUNGE



_ BE EPIC BAR



GASTRONOMY

KOJI

Our signature restaurant, KOJI, brings the spirit of Japanese culinary heritage to a stylish contemporary vibe in the heart of Lisbon.

ALLORA

Discover one of our signature restaurants, indulge in the extravagance of our authentic Italian Restaurant and Terrace - Benvenuto a ALLORA!

THE GARDEN

Start your day with a buffet breakfast in an invigorating tropical atmosphere.

SKY POOL LOUNGE

Located at the top of the EPIC SANA Marquês building, among Lisbon's high-rise buildings, it offers an exclusive and privileged experience only for hotel guests.

BE EPIC BAR

Being the first sight as you enter the hotel, BE EPIC Bar is seductive and luminous. Its green vertical walls and intimate seating area, with a piano on the side, make it the perfect place both to work and relax.

_WELLNESS TREATMENTS



SAYANNA WELLNESS & SPA

For the company's employees

Follow the example of the best companies and give your employees access to the best conditions for their well-being, receiving in return increased productivity, motivation, and reduced absence:

- 10% discount on treatments*
- 10% discount on SPA products
- 10% discount on all membership options**

For the Company

Reward the best performing employees with well-being, and you will certainly have the best and most productive ones always on your side:

Gift vouchers*:**

- 1-25 vouchers, 10% discount
- 26+ vouchers, 15% discount

Daily entrances to the SPA**:**

- 1-15 entries, 10% discount
- 16-50 tickets, 15% discount
- 50+ tickets, 20% discount

_ SPA AND INDOOR POOL



Conditions:

* Excludes aesthetic treatments. Discounts valid for all SAYANNA Wellness & SPA in Portugal. ** Valid for subscriptions contracted with monthly payment method by direct debit in a contract valid for 1 year. *** The gift vouchers can be in value or specific treatments, subject to the conditions of the SAYANNA Wellness vouchers of each unit. **** Valid for Spa entries for 1 day during normal opening hours. Discount applied **only** to tickets purchased together. Tickets valid for use in the unit where they are purchased.